

RELY ON EXCELLENCE

BT-FH.NB

Mechanical Seals | Mechanical seals for pumps | Pusher seals



Features

- Single seal
- For stepped shafts
- Balanced
- Conical spring rotating
- Dependent on direction of rotation
- Torque transmission via conical spring
- Version with shorter length available (KB)

Notes

Alternative seat ring can be supplied with short tail or long tail with slot for pin (to prevent seat rotation).

Advantages

- Universal application opportunities
- Reliable design
- Economical balanced seal
- High flexibility due to extended selection of materials
- No damage of the shaft by set screws

Operating range

Shaft diameter:

d1 = 16 ... 70 mm (0.63" ... 2.76")

Pressure: p1* = 25 bar (363 PSI)

Temperature:

t* = -35 °C ... +180 °C (-31 °F ... +356 °F)

Sliding velocity: vg = 15 m/s (50 ft/s)

* Dependent on medium, size and material

Materials

Seal face:

Silicon carbide (Q1, Q6, Q7)

Seat:

Carbon graphite antimony impregnated (A),

Carbon graphite resin impregnated (B),

Carbon graphite, full carbon (B3),

Silicon carbide (Q1, Q6, Q7)

Elastomers:

NBR (P), EPDM (E), FKM (V), FFKM (K)

Metal parts:

CrNiMo steel (G)

Standards and approvals

- EN 12756
- Various material approvals e.g. WRAS, UBA, ACS, NSF, FDA available (depending on type and material combinations). Please inquire!

Recommended applications

- Water and wastewater technology
- Building services industry
- Chemical industry
- Food and Beverage industry
- Low solid content media
- Centrifugal pumps
- Multistage vertical pumps
- Cooling water pumps
- Hot water pumps

RELY ON EXCELLENCE

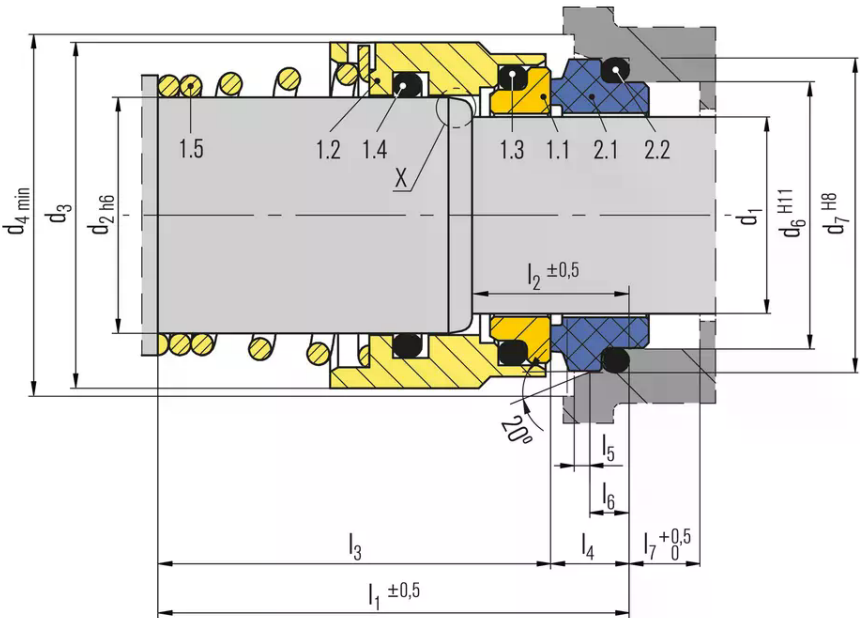

Detail X

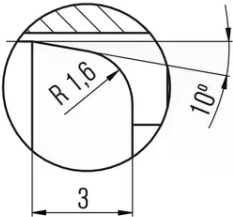

Item	Description
1.1	Seal face
2.1	Stationary seat
1.2	Collar
1.3,1.4	O-RING
1.5	Spring
1.2	Collar
2.2	O-Ring

RELY ON EXCELLENCE

Seat alternatives

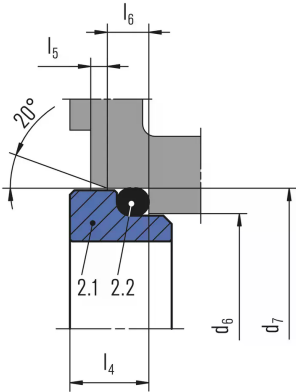

PF L

Item Description
2.1 Stationary seat
2.2 O-Ring

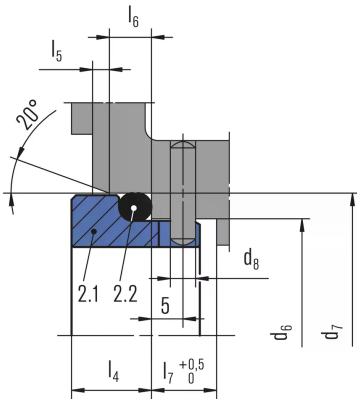

PF L1

Item Description
2.1 Stationary seat
2.2 O-Ring

RELY ON EXCELLENCE

Product variants

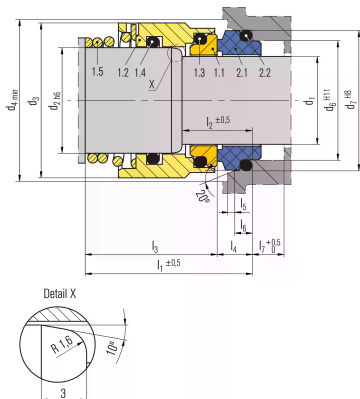

BT-FH.KB

Items and designations same as for BT-FH.NB, but with installation length l_{IK} according to EN 12756 (Short, Balanced).

Item description

- 1.1 Seal face
- 2.1 Stationary seat
- 1.2 Collar
- 1.3, 1.4 O-Ring
- 1.5 Spring
- 1.2 collar
- 2.2 O-Ring

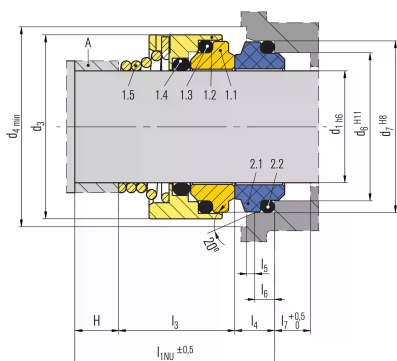

BT-FH.NU

Items and designations are the same as for BT-FH, but with installation length l_{IN} according to EN 12756 (Normal, Unbalanced).

Item description

- 1.1 Seal face
- 1.2 Collar
- 1.3 O-Ring
- 1.4 O-Ring
- 1.5 Spring
- 2.1 Stationary seat
- 2.2 O-Ring

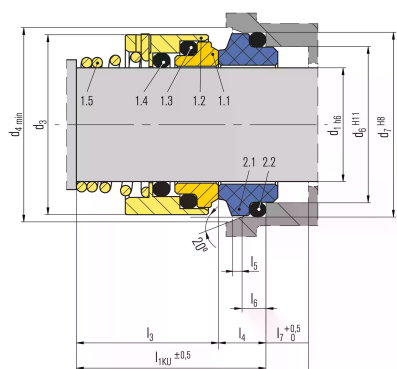

BT-FH.KU

Items and designations are the same as for BT-FH, but with installation length l_{IK} according to EN 12756 (Short, Unbalanced).

Item description

- 1.1 Seal face
- 1.2 Collar
- 1.3 O-Ring
- 1.4 O-Ring
- 1.5 Spring
- 2.1 Stationary seat
- 2.2 O-Ring

RELY ON EXCELLENCE

Dimensions

BT-FH.NB
d ₁
14
16
18
20
22
24
25
28
30
32
33
35
38
40
43
45
48
50
53
55
58
60
63
65
70

I~INB~ complies with EN 12756 (normal length, balanced) BT-FH.NB Balanced – Dimensions in millimeter